

PLANTA
ESCALA 1 : 100

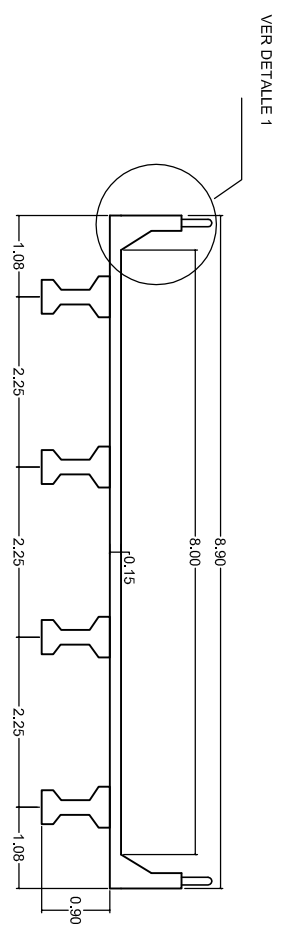

SECCION TRANSVERSAL POR E
ESCALA 1 : 100

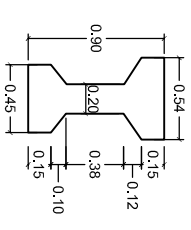

SECCION VIGA
ESCALA 1 : 50

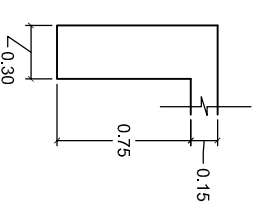

SECCION RIOSTRA EN APOYO
ESCALA 1 : 50

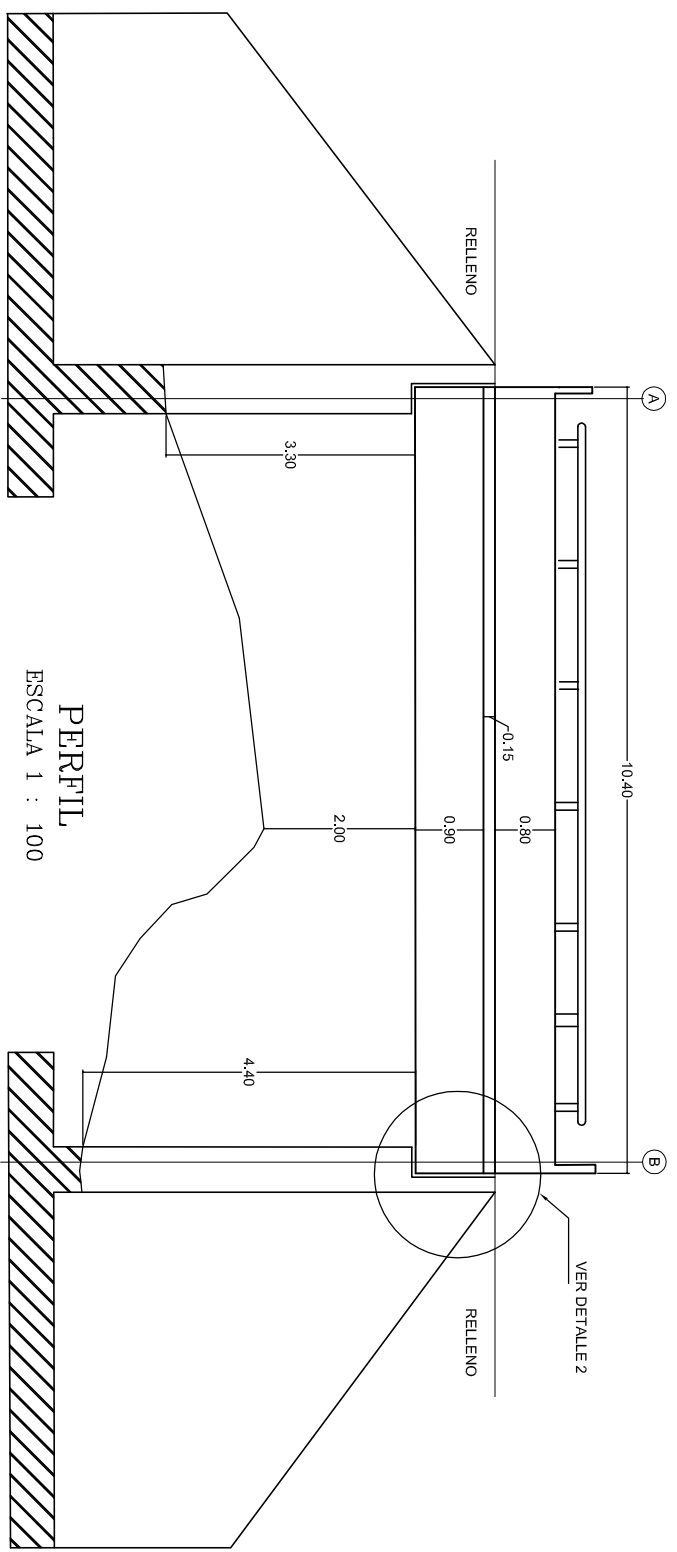

PERFIL
ESCALA 1 : 100

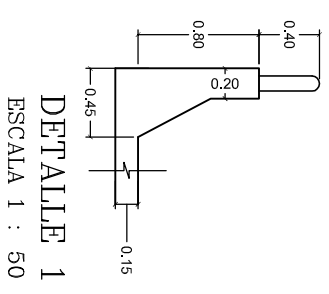



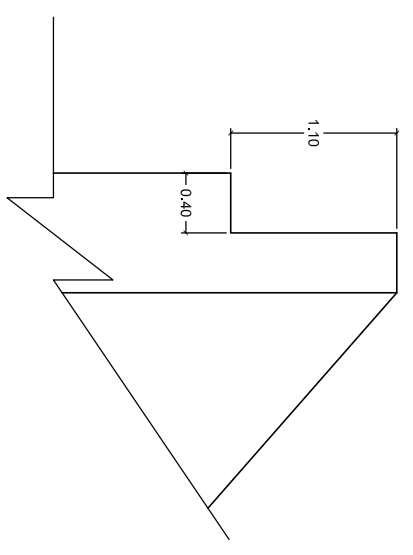

DETALLE 1
ESCALA 1 : 50



DETALLE 2
ESCALA 1 : 50

ELEMENTO ENTERRADO
MEDIDA SIN VERIFICAR

   INSTITUTO NACIONAL DE VIAS REPUBLICA DE COLOMBIA MINISTERIO DE TRANSPORTE	CONTRATO No. 2209-2011, OBJETO: ESTUDIOS DE INSPECCION E INVENTARIO DE PUENTES DE LA RED NACIONAL DE CARRETERAS EN LA ZONA NORTE EN LOS DEPARTAMENTOS DE ATLANTICO, BOLIVAR, CESAR, CÓRDOBA, GUAJIRA, MAGDALENA Y SUCRE.	 CONSULTOR: JOSE JOAQUIN ORTIZ GARCIA M.P. 25202-53601 CND	DIRECTOR CONSULTORIA: GERMAN LEMOINE A. M.P. 25202-5392 CND	INTERVENTOR: CONSORCIO LERI-CNC-F	DIRECTOR INTERVENTORIA: GERMAN LEMOINE A. M.P. 25202-5392 CND	PROYECTO: PUENTE EL TIGRE SANTA MARTA-RIO PALOMINO K46 + 580	CONTIENE: ESQUEMA GEOMETRICO DE LA SUPERESTRUCTURA PLANTA	ARCHIVO: 15-9008-018-00.dwg ESCALAS: INDICADAS	FECHA: JUNIO DE 2012 PLANO No. 01 DE 01
	ELEMENTO ENTERRADO MEDIDA SIN VERIFICAR								